

PROPOSED CONSTRUCTION OF GROUP HAND-WASHING STATION FOR HAWL-WADAG PRIMARY SCHOOL IN BAIDOA- SOUTHWEST, SOMALIA.

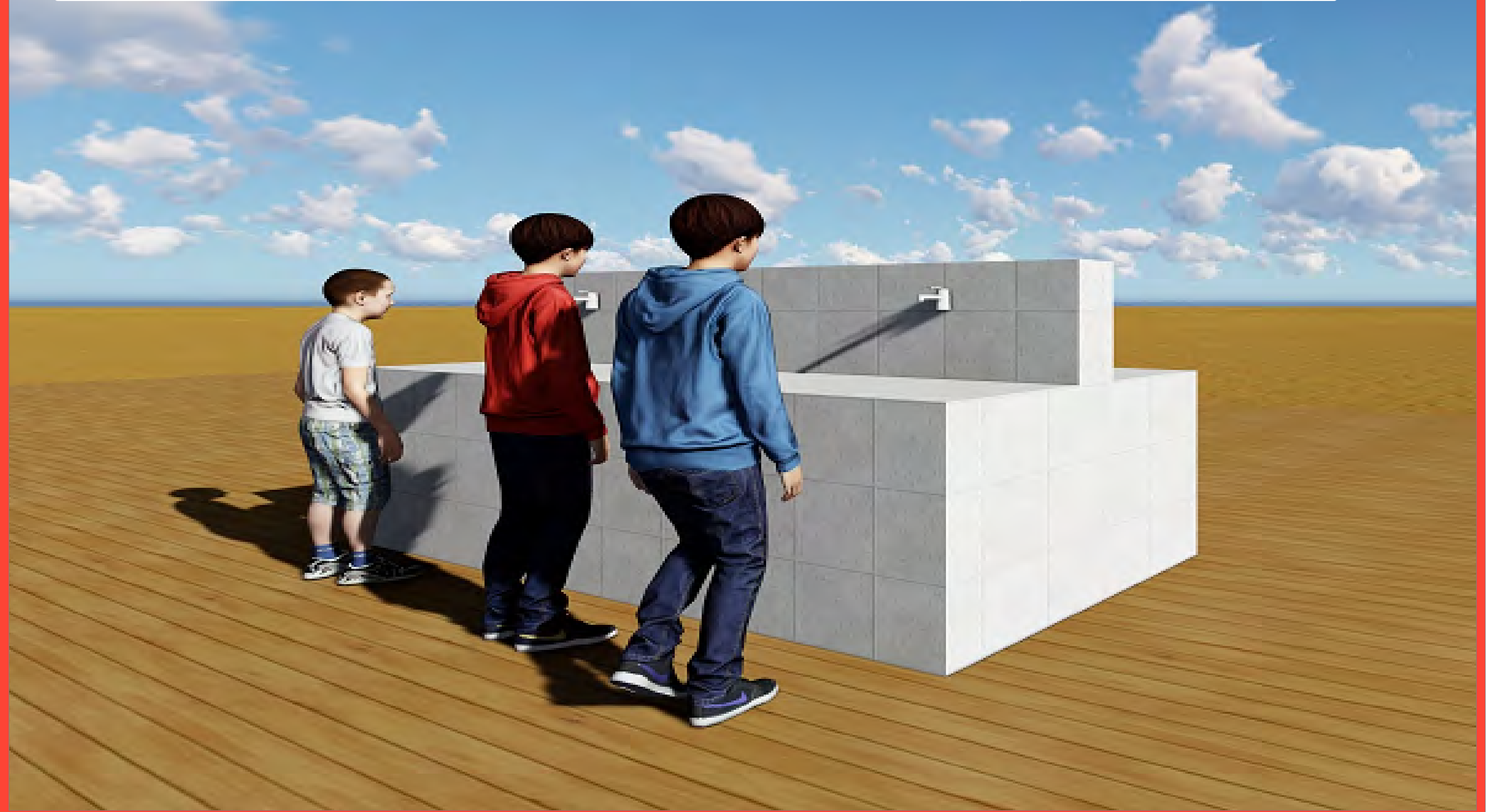

[illegible]

JULY 2021

DRAWING INDEX

[illegible]

Group hand-washing station.

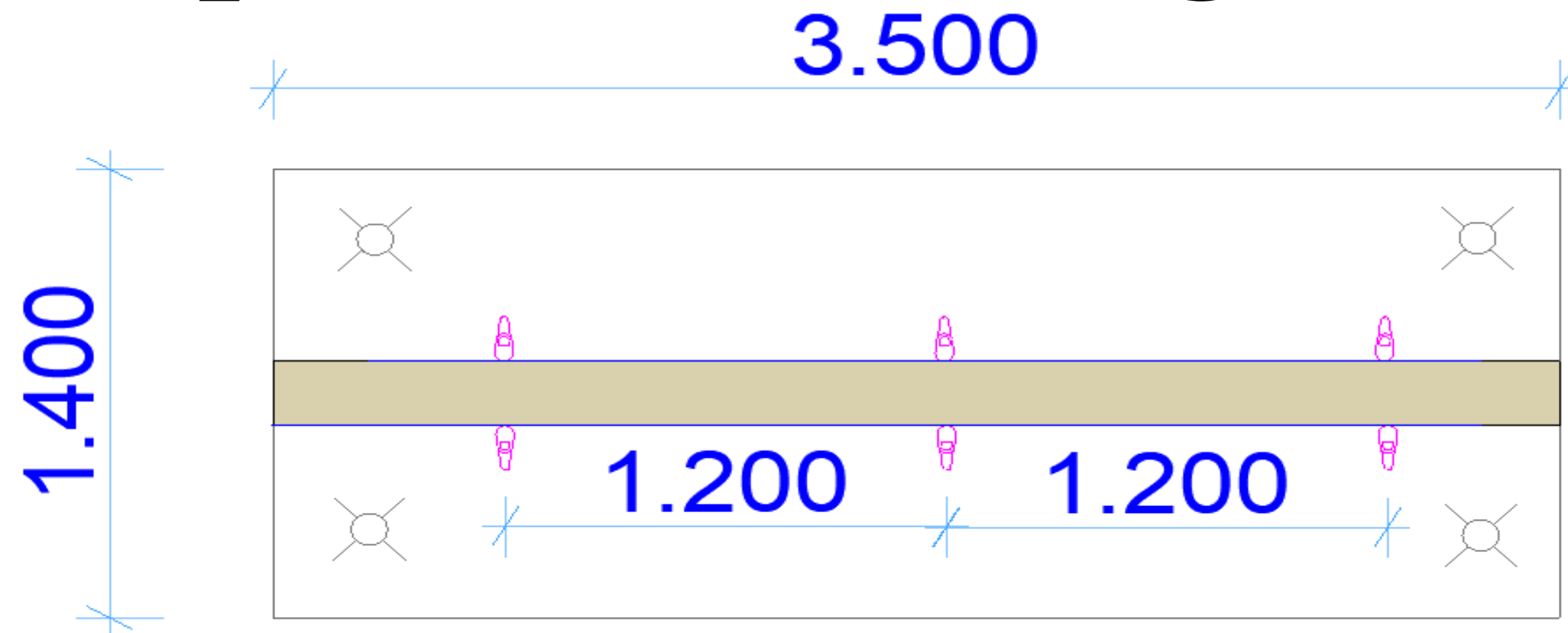

Floor Plan

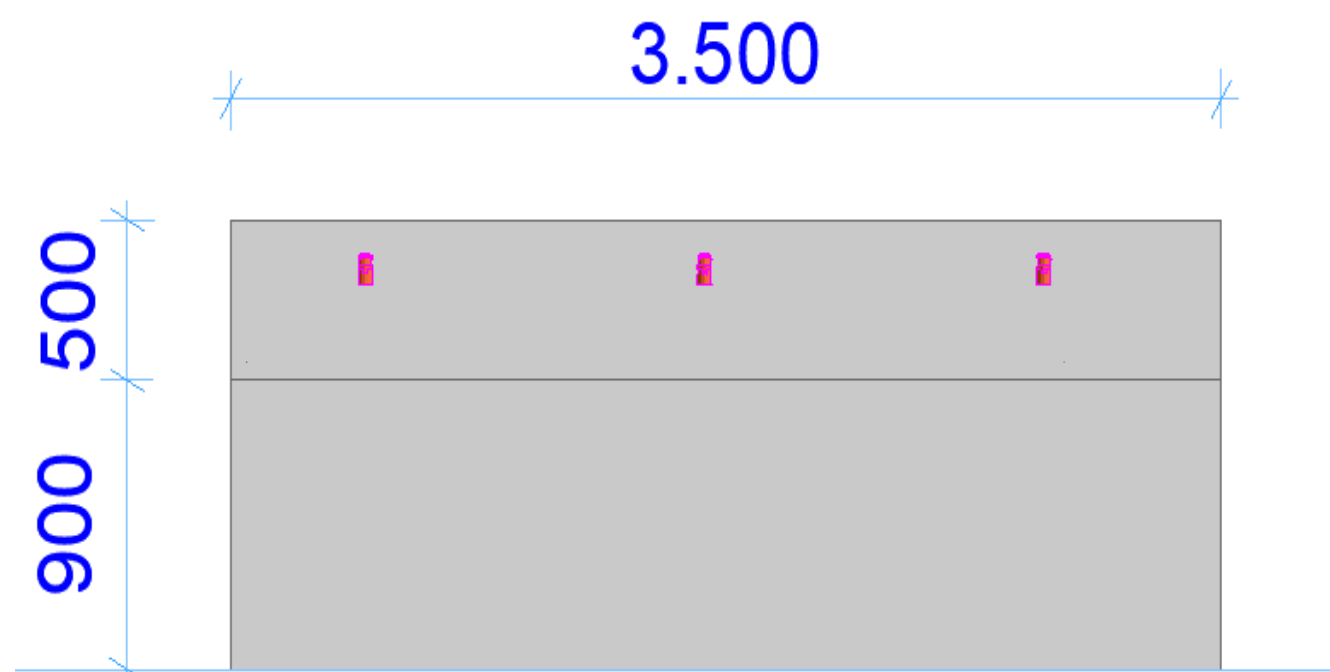

Elevation

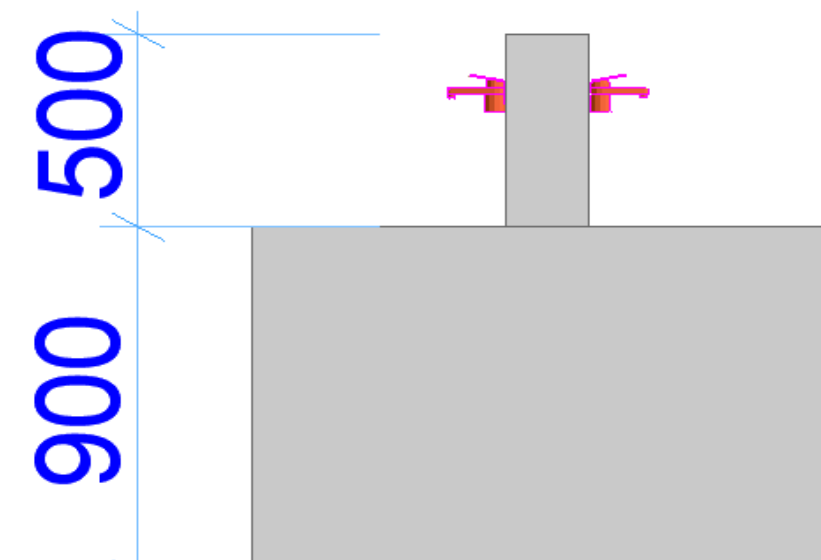

Side

PROJECT DETAILS

Client:



Implementation Partner:



ADRA SOMALIA

Project title:

PROPOSED CONSTRUCTION OF GROUP HANDWASHING STATION FOR WAL-WADAAG PRIMARY SCHOOL IN BAIDOA- SOUTHWEST, SOMALIA.

Drawing Title:

Plan & Elevations

Reviewed by:

Eng. Moffat

Drawn by:

Eng. Abdirizak Dahir

Checked by:

Sheet No.

03

Scale: N/A

Date: July, 2021

ARCHITECTURAL DRAWINGS

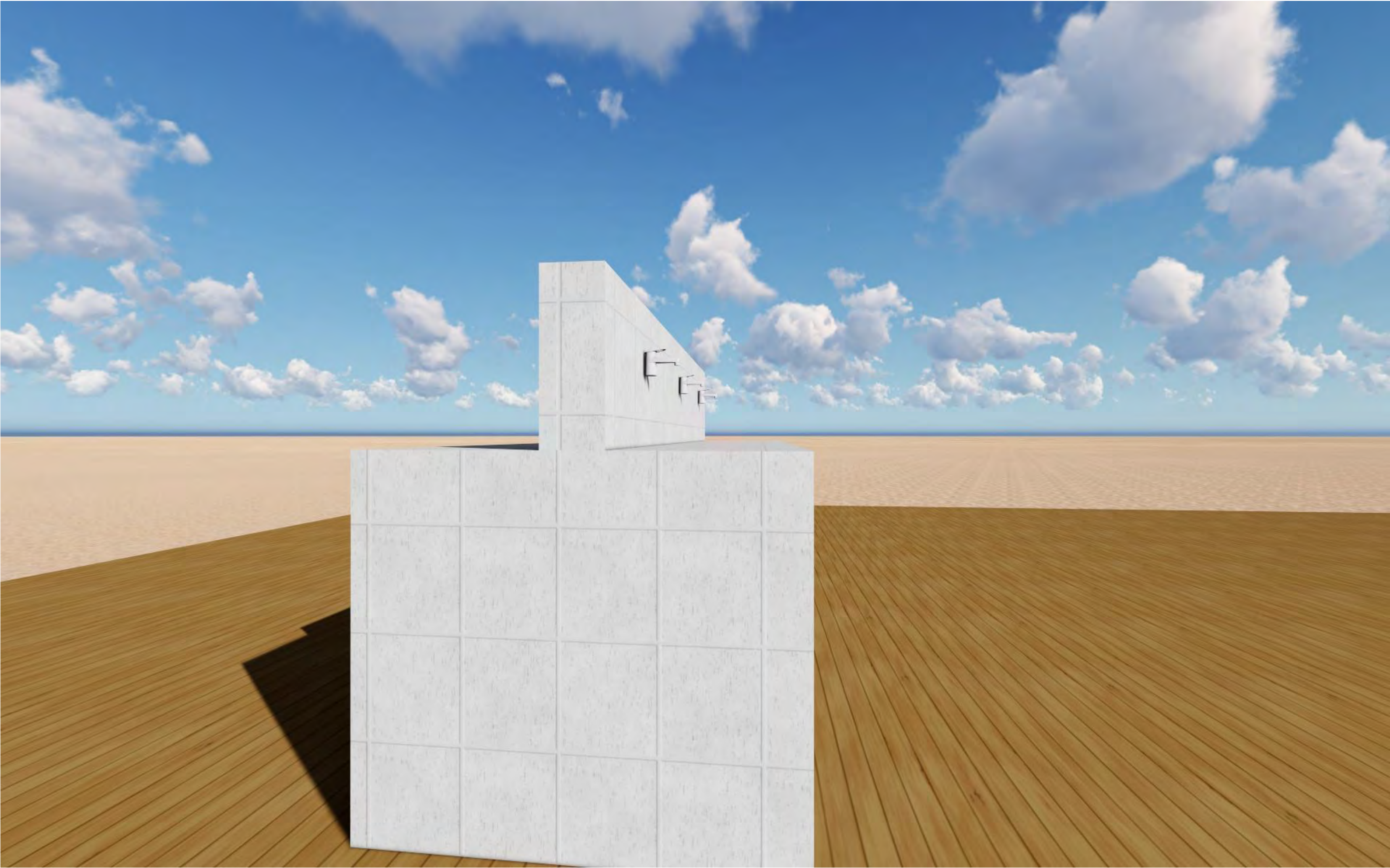

PROJECT DETAILS

Client:



Implementation Partner:



ADRA SOMALIA

Project title:

PROPOSED CONSTRUCTION OF GROUP HANDWASHING STATION FOR WAL-WADAAG PRIMARY SCHOOL IN BAIDOA- SOUTHWEST, SOMALIA.

Drawing Title:

Reviewed by:

Eng. Moffat

Drawn by:

Eng. Abdirizak Dahir

Checked by:

Sheet No.

07

Scale: N/A

Date:

July, 2021

ARCHITECTURAL DRAWINGS